

Ventilation Plugs Polyamide

Ventilation plugs

- Balances pressure differences between inner housing and the outside environment.
- Prevents damages according to pressure differences.
- Prevents the formation of water condensation in tightly-sealed standard housings.
- Membrane properties: hydrophobic, oleophobic.

Technical Details

| | | |
|----------------------------------|---|---------------------|
| Body | PA 6 (Polyamide 6) | |
| Material | Acrylic co-polymer on nylon-support | |
| O-Ring | NBR (standard for A , D and E types) | |
| Gaskets | NBR (standard for B , J and F types) | |
| Ingress Protection Rating | IP 68 / IP 67 (for water intrusion pressure 0.1 bar) IP 69K (only for D type) | |
| Flammability | V2 according to UL94 | |
| Operating Temperature | Permanent | Intermittent |
| | -40 °C to +100 °C | -45 °C to +150 °C |
| Thread Type | <ul style="list-style-type: none"> • Metric EN 60423 • without thread | |
| Accessories | <ul style="list-style-type: none"> • Lock nuts | |
| Remarks | <ul style="list-style-type: none"> • Some approvals do not cover all colours or sizes. | |



TYPE 4X

E350312

UL508A
UL50E
CAN/CSA C22.2 No.14-2010

For details of approvals, see our website.

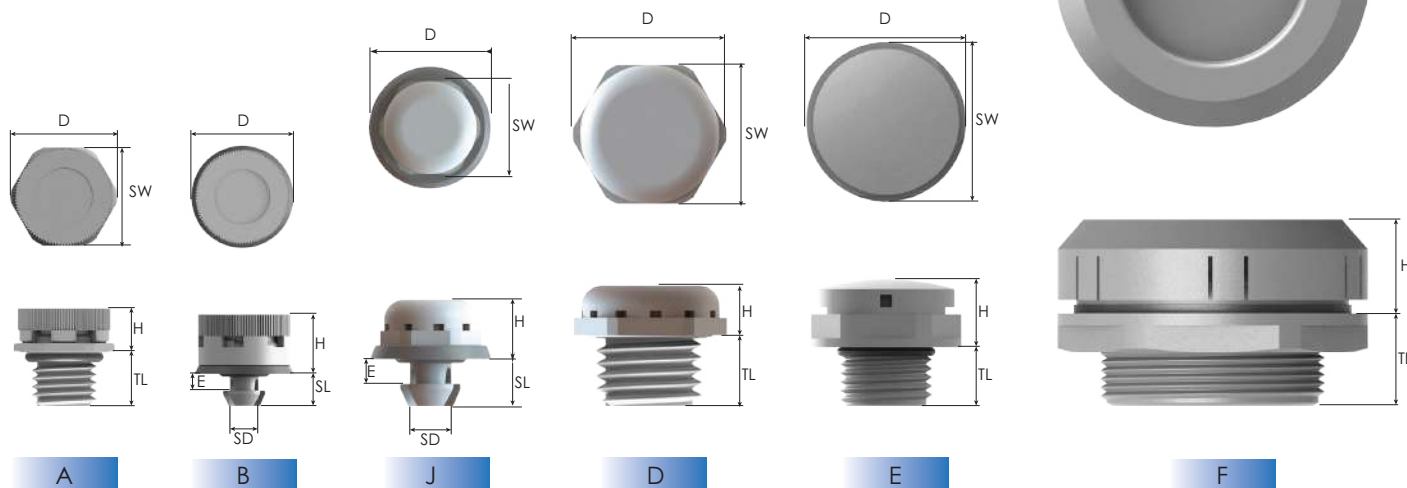

Hole Details for B and J Type Snap-Fit Ventilation Plug

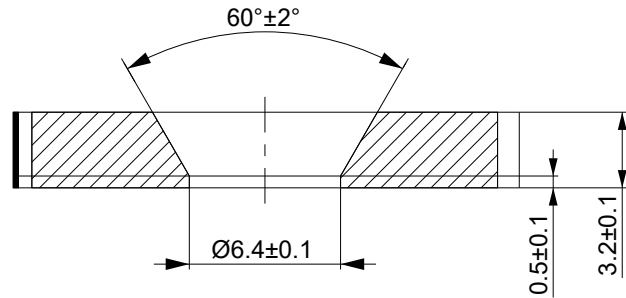

Ventilation Plugs Polyamide

Thread Type METRIC acc. to EN 60423

| Outer Thread Size (Male) | Average Air Flow for $\Delta P = 70$ mbar/1 psi | Water Intrusion Pressure | Outer Thread Length | Spanner Width | Outer \varnothing | | Height | Design Type | Part Number | | |
|--------------------------|---|--------------------------|---------------------|---------------|---------------------|------|-----------|-------------|---------------------|---------------|----------------|
| | | | | | D mm | H mm | | | RAL 7035 light grey | RAL 7001 grey | RAL 9005 black |
| M6x0,75 | 8 | 0,5 | 10,0 | 10 | 11,0 | 6,15 | D | MBVPG-11 | MBVPG-01 | MBVPG-21 | |
| M8x1,0 | 15 | 0,5 | 10,0 | 12 | 13,0 | 6,15 | D | MBVPG-12 | MBVPG-02 | MBVPG-22 | |
| M12x1,0 | 16 | 0,9 | 6,6 | 17 | 18,5 | 7,6 | A | SBVPA-11 | SBVPA-01 | SBVPA-21 | |
| | 25 | 0,5 | 6,6 | 17 | 18,5 | 7,6 | A | MBVPA-11 | MBVPA-01 | MBVPA-21 | |
| | 120 | 0,2 | 6,6 | 17 | 18,5 | 7,6 | A | HBVPA-11 | HBVPA-01 | HBVPA-21 | |
| | 300 | 0,1 | 6,6 | 17 | 18,5 | 7,6 | A | UHBVPA-11 | UHBVPA-01 | UHBVPA-21 | |
| M12x1,5 | 25 | 0,5 | 10,0 | 17 | 18,8 | 5,65 | D | MBVPG-13 | MBVPG-03 | MBVPG-23 | |
| | 16 | 0,9 | 6,0 | 17 | 18,5 | 7,6 | A | SBVPB-11 | SBVPB-01 | SBVPB-21 | |
| | 16 | 0,9 | 10,0 | 17 | 18,5 | 7,6 | A | SBVPB-11L | SBVPB-01L | SBVPB-21L | |
| | 25 | 0,5 | 6,0 | 17 | 18,5 | 7,6 | A | MBVPB-11 | MBVPB-01 | MBVPB-21 | |
| | 25 | 0,5 | 10,0 | 17 | 18,5 | 7,6 | A | MBVPB-11L | MBVPB-01L | MBVPB-21L | |
| | 42 | 0,9 | 10,0 | 24 | 26,0 | 11,7 | E | SBVPD-11 | SBVPD-01 | SBVPD-21 | |
| | 120 | 0,5 | 10,0 | 24 | 26,0 | 11,7 | E | MBVPD-11 | MBVPD-01 | MBVPD-21 | |
| | 120 | 0,2 | 6,0 | 17 | 18,5 | 7,6 | A | HBVPB-11 | HBVPB-01 | HBVPB-21 | |
| | 120 | 0,2 | 10,0 | 17 | 18,5 | 7,6 | A | HBVPB-11L | HBVPB-01L | HBVPB-21L | |
| | 300 | 0,1 | 6,0 | 17 | 18,5 | 7,6 | A | UHBVPB-11 | UHBVPB-01 | UHBVPB-21 | |
| | 300 | 0,1 | 10,0 | 17 | 18,5 | 7,6 | A | UHBVPB-11L | UHBVPB-01L | UHBVPB-21L | |
| | 450 | 0,2 | 10,0 | 24 | 26,0 | 11,7 | E | HBVPD-11 | HBVPD-01 | HBVPD-21 | |
| 750 | 0,1 | 10,0 | 24 | 26,0 | 11,7 | E | UHBVPD-11 | UHBVPD-01 | UHBVPD-21 | | |
| M16x1,5 | 42 | 0,9 | 10,0 | 24 | 26,0 | 11,7 | E | SBVPF-11 | SBVPF-01 | SBVPF-21 | |
| | 120 | 0,5 | 10,0 | 24 | 26,0 | 11,7 | E | MBVPF-11 | MBVPF-01 | MBVPF-21 | |
| | 450 | 0,2 | 10,0 | 24 | 26,0 | 11,7 | E | HBVPF-11 | HBVPF-01 | HBVPF-21 | |
| | 750 | 0,1 | 10,0 | 24 | 26,0 | 11,7 | E | UHBVPF-11 | UHBVPF-01 | UHBVPF-21 | |
| M20x1,5 | 42 | 0,9 | 10,0 | 24 | 26,0 | 11,7 | E | SBVPE-11 | SBVPE-01 | SBVPE-21 | |
| | 120 | 0,5 | 10,0 | 24 | 26,0 | 11,7 | E | MBVPE-11 | MBVPE-01 | MBVPE-21 | |
| | 450 | 0,2 | 10,0 | 24 | 26,0 | 11,7 | E | HBVPE-11 | HBVPE-01 | HBVPE-21 | |
| | 750 | 0,1 | 10,0 | 24 | 26,0 | 11,7 | E | UHBVPE-11 | UHBVPE-01 | UHBVPE-21 | |
| M40x1,5 | 120 | 0,9 | 18,0 | - | 55,3 | 15,5 | F | SBVPX-18S | SBVPX-08S | SBVPX-28S | |
| | 375 | 0,5 | 18,0 | - | 55,3 | 15,5 | F | MBVPX-18S | MBVPX-08S | MBVPX-28S | |
| | 1350 | 0,2 | 18,0 | - | 55,3 | 15,5 | F | HBVPX-18S | HBVPX-08S | HBVPX-28S | |
| | 2200 | 0,1 | 18,0 | - | 55,3 | 15,5 | F | UHBVPX-18S | UHBVPX-08S | UHBVPX-28S | |

wall thickness (E) : 3,2 mm

| Snap Size | Average Air Flow for $\Delta P = 70$ mbar/1 psi | Water Intrusion Pressure | Snap | | Outer \varnothing | Spanner Width | Height | Design Type | Part Number | | |
|-------------|---|--------------------------|--------------|---------------------|---------------------|---------------|--------|-------------|-------------|-----------|-----------|
| | | | Length SL mm | \varnothing SD mm | | | | | D mm | SW mm | H mm |
| Snapfit 5,5 | 16 | 0,9 | 5,9 | 5,4 | 18,5 | - | 10,9 | B | SBVQ-M11 | SBVQ-M01 | SBVQ-M21 |
| | 25 | 0,5 | 5,9 | 5,4 | 18,5 | - | 10,9 | B | MBVQ-M11 | MBVQ-M01 | MBVQ-M21 |
| | 120 | 0,2 | 5,9 | 5,4 | 18,5 | - | 10,9 | B | HBVQ-M11 | HBVQ-M01 | HBVQ-M21 |
| | 300 | 0,1 | 5,9 | 5,4 | 18,5 | - | 10,9 | B | UHBVQ-M11 | UHBVQ-M01 | UHBVQ-M21 |

wall thickness (E) : 3,2 mm

| | | | | | | | | | | | |
|-------------|----|-----|-----|-----|------|----|------|---|-----------|-----------|-----------|
| Snapfit 5,5 | 15 | 0,5 | 5,9 | 5,4 | 15,0 | 12 | 7,75 | J | MBVPGQ-12 | MBVPGQ-02 | MBVPGQ-22 |
| | 25 | 0,5 | 5,9 | 5,4 | 18,5 | 17 | 7,05 | J | MBVPGQ-13 | MBVPGQ-03 | MBVPGQ-23 |